

Ballroom Layout

Rental Date:

Rental Name:

_____ Round Tables

_____ Chairs

NOTE: Layout is not to scale.
4' clearance between tables

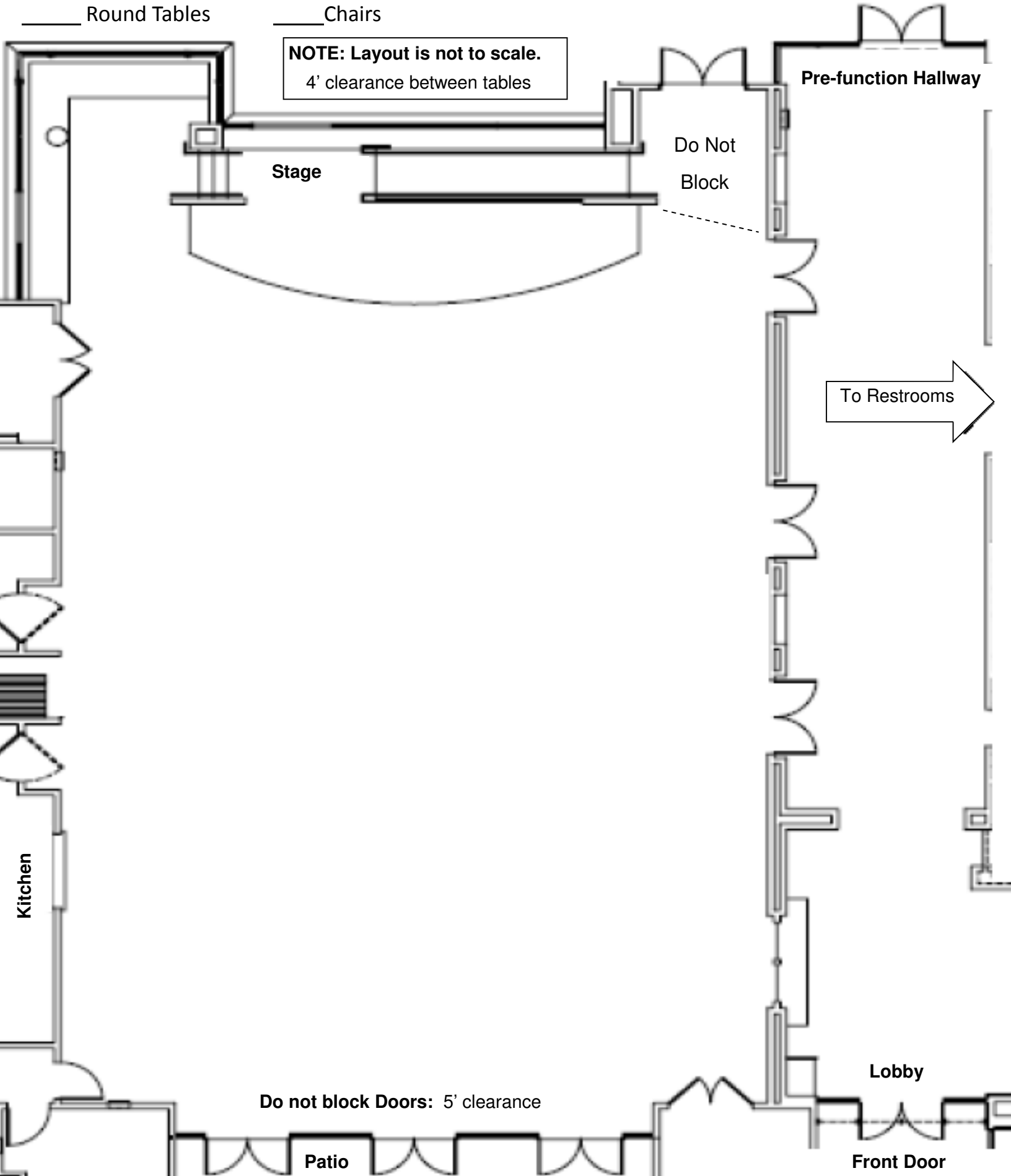

Stage

Do Not
Block

Pre-function Hallway

To Restrooms

Kitchen

Do not block Doors: 5' clearance

Lobby

Patio

Front Door

Senior Center Ballroom Capacity

(based on use type):

Maximum Dining without dance floor:

- 224 chairs
- 28 round tables, 6 chairs around each table
- buffet in hallway

Maximum Dining with dance floor:

- 200 chairs, 25 round tables
- buffet in hallway

Assembly, auditorium seating:

- 300 chairs
- chairs only, no tables

NOTE: Layout is not to scale.

4' clearance between tables

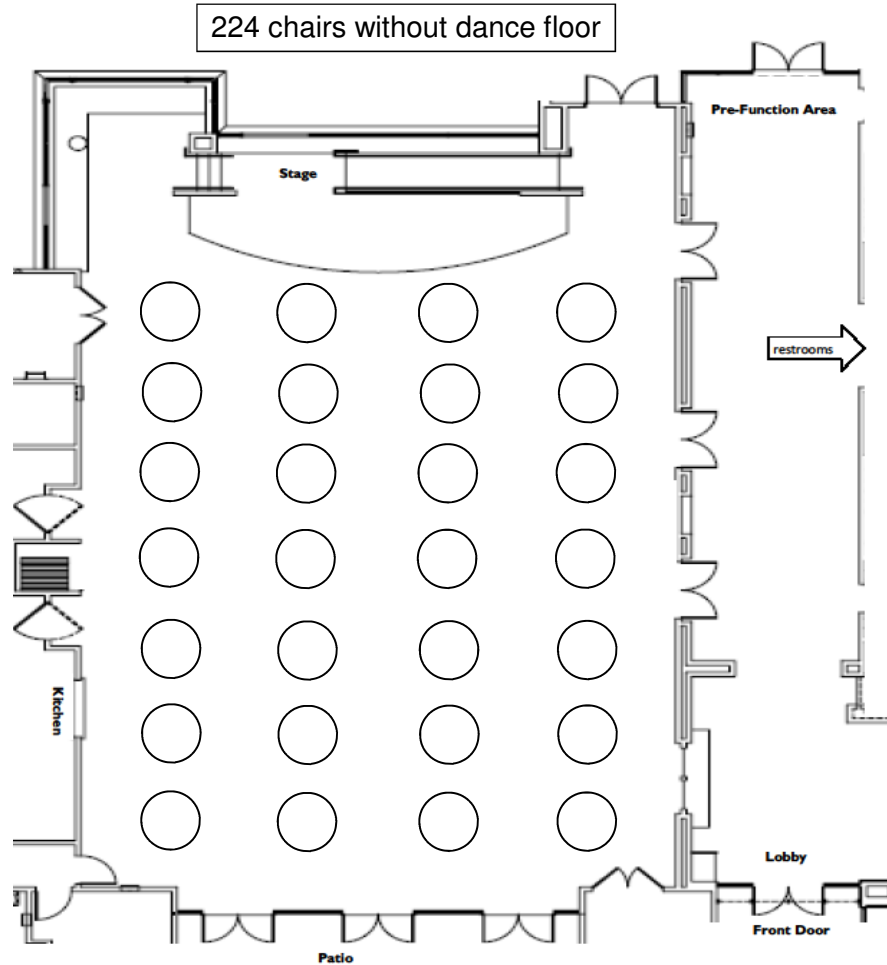

200 chairs with dance floor

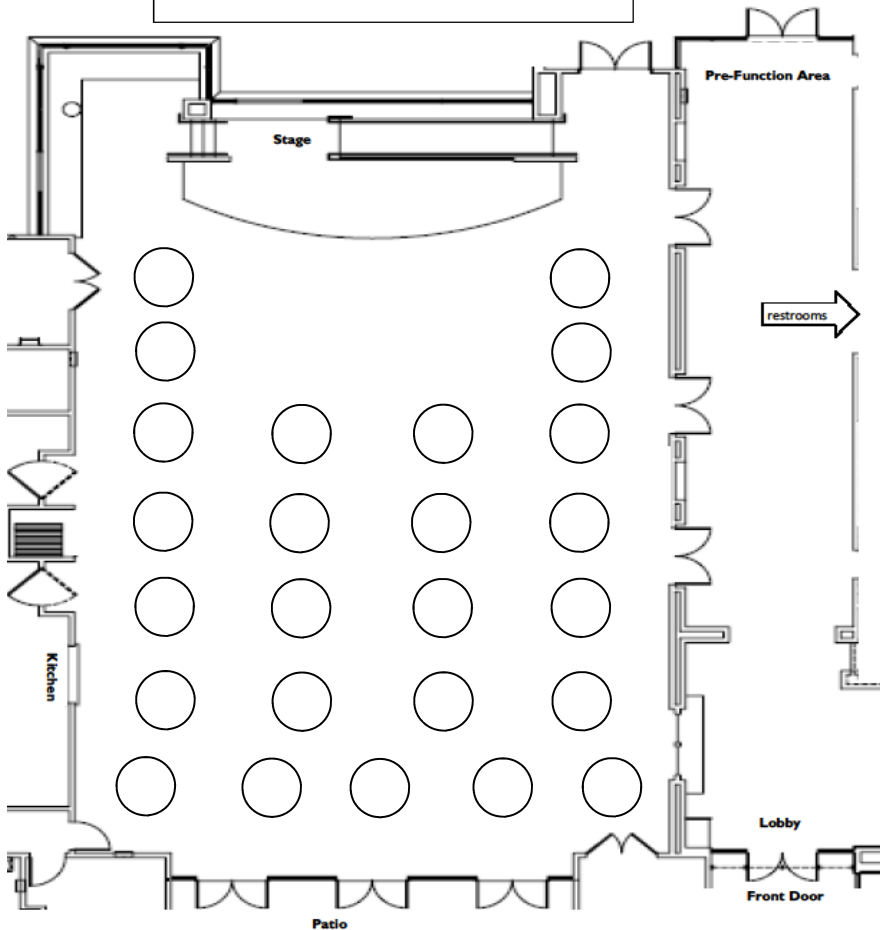

Items Available

(with no additional charge)

- _____ Round Tables - (60" diameter) - 28 available
seats 6 comfortably, 8 chairs maximum
- _____ Rectangular Tables - (5' width) - 25 available
- _____ Rectangular Tables - (6' width) - 8 available
- _____ Rectangular Tables - (8' width) - 2 available
- _____ Banquet Chairs - 240 available
- _____ Card Tables - 5 available
- _____ Podium - (45"H x 22.5"W x 19.5"D)